

NOTE:
Discrepancies to be brought to the attention of the author. Not for construction.
Any areas given are approximate only and should be checked with the QS.
Electronic drawings are uncontrolled documents and are issued for information only. Any dimensions not nominated must be referred to the author for confirmation.
© The CDS Group
This document should not be relied on or used in circumstances other than those for which it was originally prepared and for which The CDS Group were commissioned.

- KEY:
- APPLICATION BOUNDARY (7779 m², 1.9 ACRES, 077 HA)
 - STANDARD BURIAL PLOT AREA
 - CREMATED REMAINS AREA
 - CHILD AND BABY AREA
 - MUSLIM AREA
 - BUILDING AND MAINTENANCE AREA LOCATION
 - TARMAC ROADWAYS AND PARKING
 - TARMAC PEDESTRIAN PATHWAYS
 - EXISTING VEGETATION
 - EXISTING TREES
 - PROPOSED TREES
 - PROPOSED NATIVE SCREEN HEDGING
 - PROPOSED RAIN GARDENS
 - PROPOSED LANDSCAPED AREAS
 - PROPOSED 3M HEDGE OFFSET ZONE
 - BURIAL PLOTS (TOTAL 590)
 - CREMATED REMAINS PLOTS (TOTAL 253)
 - CREMATED REMAINS PLOTS (TOTAL 253)
 - PROPOSED WOODEN BENCH

TYPICAL HARDWOOD WOODEN GATES

Five-bar wooden field gate for durability, ensuring decades of outdoor performance with minimal maintenance. Naturally complementing the surrounding countryside and rustic feel of the existing cemetery



TYPICAL MEMORIAL GARDEN

The memorial garden would be designed to create an atmosphere of peaceful natural solitude, a quiet space for emotional comfort: personal reflection, grief processing, and healing with the changing seasonal growth symbolising the renewal of life.

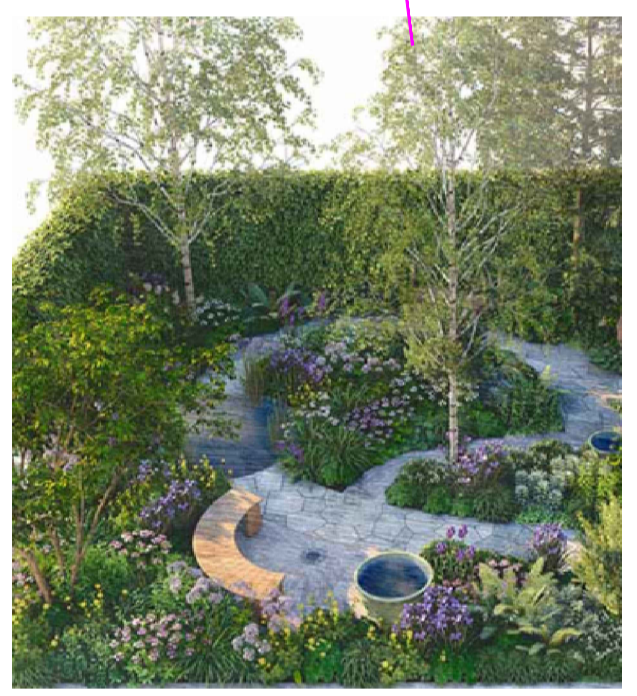

GENERAL NOTES:

Aligning headstones with natural landscape contours creates a harmonious, park-like cemetery layout and flows with the natural environment. Having a standard headstone heights relative to the contour row help maintain a clean, rhythmic line across the landscape. Having the pedestrian paths to cut diagonally across the contours, ensures comfortable walking grades for visitors.

Positioning burial rows parallel to the contours minimises soil erosion, and ensures structural stability on sloped terrain. It also prevents headstones from tilting or shifting downhill over time and naturally channel rainwater away from grave sites and mitigate soil pooling.

The flat terrace tops provide stable ground for standard grave digging and level monument installation. This also allows standard mowing equipment and mini-excavators to traverse slopes safely without tipping.

The Health and Safety Executive (HSE) and local highway authorities typically recommend a maximum gradient of 1 in 12 (approx. 8%) for general road safety for all users, including funeral limousines and pedestrians.

Steepest Limit: Gradients steeper than 1 in 10 (10%) are generally avoided for traffic routes as they can affect vehicle stability and braking distance.

RAIN GARDEN

A rain garden is a garden of native shrubs, perennials, and flowers planted in a small depression, which is generally formed on a natural slope. It is designed to temporarily hold and soak in rain water runoff. The rain garden is dry most of the time. It typically holds water only during and following a rainfall event



300mm x 300mm CREMATED REMAINS PLOTS

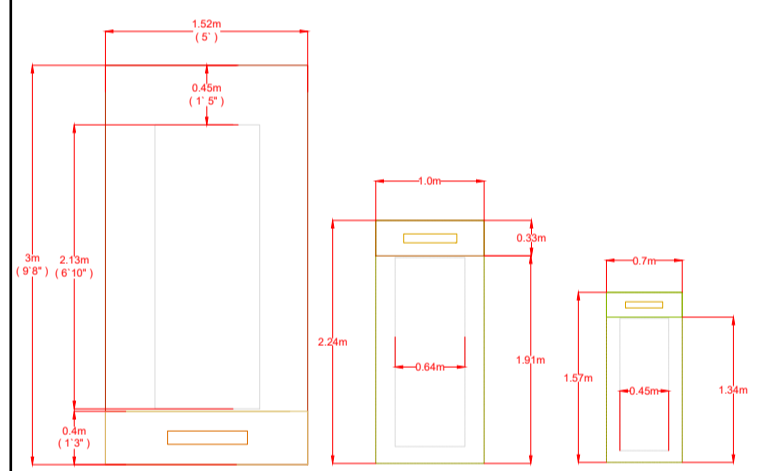
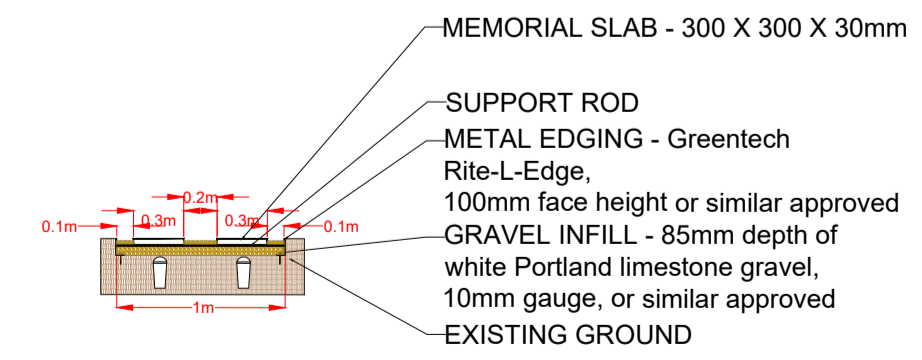
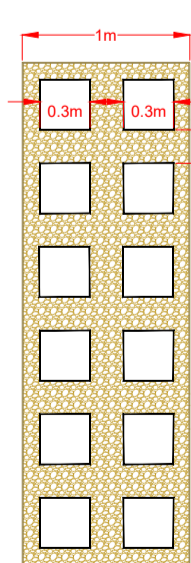

Hedge Offset zone enables the cutting machinery or operator a 3m zone away from the hedge face using specialized reach mowers or long-reach trimmers. This helps prevent physical impact of Graves and Memorials and eliminates tree and vegetation encroachment especially in a sensitive environment like a cemetery.

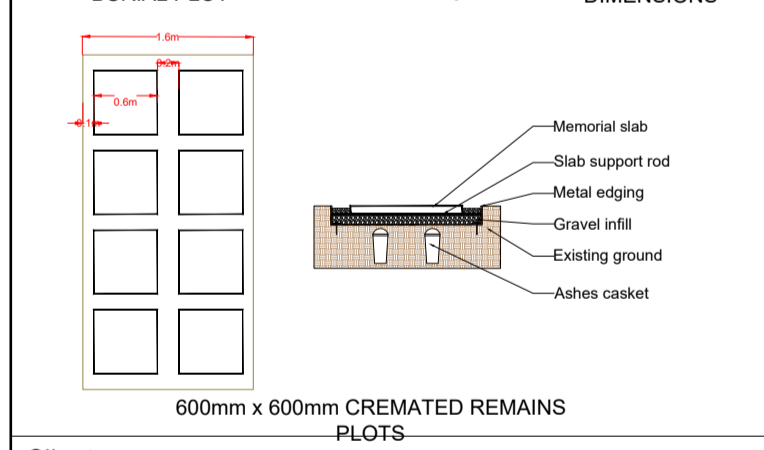

NOTES:
THIS DRAWING CAN ONLY BE CONSIDERED AS A GENERAL CONCEPT FOR DEVELOPMENT. SUBJECT TO CHANGE WITH UPDATED TOPOGRAPHICAL SURVEY, DRAINAGE PROPOSALS DETENTION BASIN SIZE, ARBORICULTURAL & ECOLOGY SURVEYS WITH REGARD TO BIODIVERSITY NET GAIN.

Client: **Ludlow Town Council**

Project: **Henley Road Cemetery Extension**
Address: Henley Road Cemetery, Ludlow, SY8 1RA

Title: **Client Plan**

Drawing No: **CDS-C1177-P01-L-003** Rev: **001**

Scale: **1:250 @ A1** Date: **05.06.2026**

Drawn By: **PC**
Checked By: **IM**
Authorised By: **AM**

B-51 West Park | Silsoe | Bedford | MK45 4HS

www.thecdsgroup.co.uk | info@thecdsgroup.co.uk | 01525 864387