

Ludlow in Bloom 2011

The Heart of England judges visited Ludlow on 18th July 2011 and were given a tour of Ludlow by the in Bloom Committee. The route took in this year's glorious flower displays including Castle Gardens, Old Street and the wonderful flower beds in St John's Gardens. The tour also included wildlife habitats at Gallows Bank, Millennium Green and Ludlow's award winning market was the subject of one of the informative talks en route, which also included the plans for the revitalisation of The Linney Riverside Park. Delightful entertainment was provided by St Laurence's School choir and a female acapella group. The Ludlow in Bloom Committee, Ludlow Town Council's grounds maintenance team and Shropshire Council Street Scene work together each year to make sure Ludlow looks its best. In 2009 and 2010, Ludlow won Gold and

hopes are high for repeat success in 2011. Results will be known in September.



Castle Garden



New for 2012 – The Town Council will be growing plants for the beds and borders of Ludlow in a new poly tunnel.

The Linney Riverside Park Update

Congratulations to the Friends of Linney Riverside Park and everyone who has supported their efforts on a successful £50,000 bid, which is a huge step towards the revitalisation of the Linney. Town Clerk Veronica Calderbank and Projects Officer Chris Bayliss assisted the Friends in making their successful bid.

The project is also supported by S106 funding allocated for recreational facilities in Ludlow by Shropshire Council.



Mayor of Ludlow & Friends of Linney Riverside Park

The first stage of the Linney project is stabilising the bank erosion. The design for this work has been approved by the Environment Agency and work began in early August. The Linney is and always will be a flood plain, and the bank works will prevent further erosion so that play equipment (proposed layout pictured left) can be installed. Other facilities include picnic tables, toilets and a car park. Expressions of interest are also invited for a boating and refreshment concession.

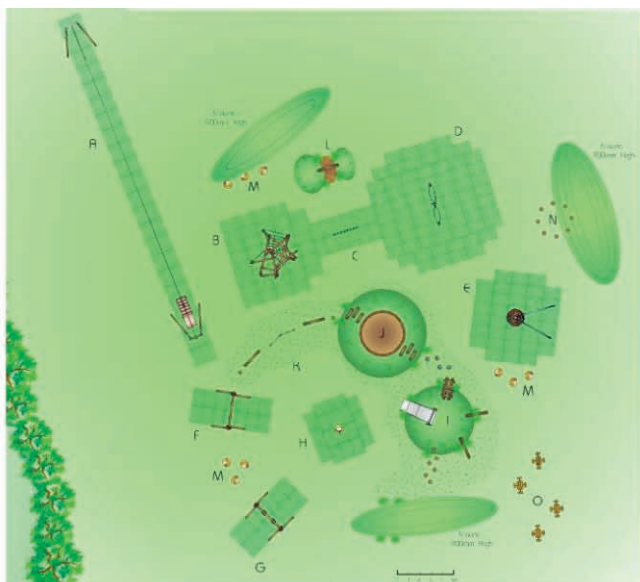

Houseman Crescent Play Area

In excess of £10,000 has been allocated to refurbish existing swings, see-saw, slide and the introduction of safe play surfacing and new multi-function climbing equipment.

